

REV	LTR	DESCRIPTION	DATE	APPROVED
A0		依新料号给码原图发行		

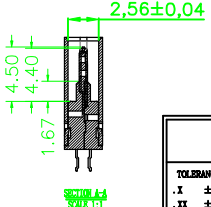
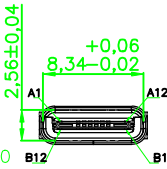
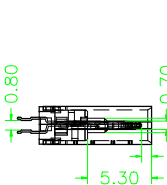
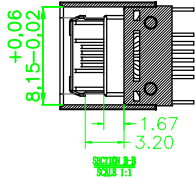
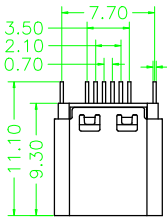

- 备注:
- 1.1 胶态: LCP+30%G.F UL94V-0
 - 1.2 端子: 磷铜, T=0.12mm; 锡底, 镀金1μ
 - 1.3 外壳: 不锈钢, T=0.30mm; 表面镀锌100μ 或亮镍100μ
2. 主要特性:
- 2.1 额定电流: 0.5A
 - 2.2 接触阻抗: 30mΩ MAX
 - 2.3 绝缘阻抗: 100MΩ MIN 250V DC
 - 2.4 耐压测试: 250V AC
 - 2.5 沾锡性: 温度250±5℃, 时间5±0.5s
 - 2.6 整体插入力: 3.57kgf MIN
整体拔出力: 1.02kgf MAX
 - 2.7 使用寿命: 10000次
 - 2.8 工作温度: -30℃~+80℃

PIN ASSIGNMENT:

Pin No.	Signal Name	Pin No.	Signal Name
A1	CHD	B15	CHD
A2	CHD	B11	CHD
A3	CHD	B10	CHD
A4	YBUS	B9	YBUS
A5	OC1	B8	SRQ
A6	D+	B7	D-
A7	D-	B6	A+
A8	SW1	B5	OC2
A9	YBUS	B4	YBUS
A10	CHD	B3	CHD
A11	CHD	B2	CHD
A12	CHD	B1	CHD

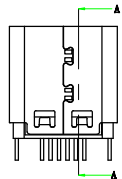

TOLERANCES		TITLE:	
.X	±0.30	APPL:	USB 3.1 Type-C/P 14P17H 母座无叉脚失插0.00成品
.XX	±0.20	DRAWING NO.:	
.XXX	±0.10	REV.:	A/0
ANGLES	±3.00°	SIZE:	A4
		UNIT:	MM
		SCALE:	1:1
		SHEET:	1 / 1