

# SPECIFICATION

SHEET FOR APPROVAL

CUSTOMER:

CUSTOMER MODEL NO:

PRODUCTS: SPEAKER

MODEL: **HY20N08H060L020-046**

DATE: 2012-05-10

MODEL NO:  $\Phi 20$   $8 \Omega$  0.8W 6.0H 引线 L=20mm

APPROVED	CHECKED	DESIGNED

CUSTOMER APPROVED

SIGNATURE	IMPRINTMENT

	<b>SPECIFICATIONS</b>	4-1
	TYPE NO.	<b>HY20N08H060L020-046</b>
1.PRODUCT OUTLINE		
1-1 SCOPE	This specification is a typical speaker unit for telephone hand set	
1-2 DIMENSIONS	As shown in fig (1)	

1-3	NET WEIGHT	APPROX. 1.2 grams				
1-4	OPERATING TEMPERATURE	-30°C to +70°C				
1-5	STORAGE TEMPERATURE	-40°C to +85°C				
2. ELECTROACOUSTIC CHARACTERISTICS						
2-1	TEST SET UP	Measuring conditions and procedures shown in fig(2)				
2-2	IMPEDANCE	8 Ω ±15% ohm ( at 2 KHz, 0.9Vrms )				
2-3	SOUND PRESSURE LEVEL	92dB ±3dB SPL /1W/10mm at 800、1000、1200、1500Hz .AVE				
2-4	FREQUENCY RESPONSE	800 ±20%HZ				
2-5	INPUT POWER (NOM. /MAX. )	0.8W/1.0W				
2-6	AUDIBLE NOISE	Must be free audible noise (buzzes and rattles) (200 ~ 10KHz frequency range ,input level up to 2.53Vrms)				
2-7	DISTORTION	Less than 10% at 1KHz 0.8W				
C H A N G E S						
	NO.	DATE	BEFORE	AFTER	REASON OF CHANGE	SIGN.
		<b>SPECIFICATIONS</b>				4-2
		TYPE NO.	<b>HY20N08H060L020-046</b>			
3.RELIABLE TEST						
3-1	GENERAL	After any following tests the response at 1 KHz shall not deviate more than ±3 dB from the initial value				

3-2 LOAD TEST	Input power: 0.8 W ,white noise 48 hours
3-3 HUMIDITY TEST	Temperature: $+40^{\circ}\text{C} \pm 2^{\circ}\text{C}$ Relative Humidity: 90%~95% Duration: 48hours      (recovery 6 hours)
3-4 DROP TEST	Height: 1.0M Cycle: 10cycles
3-5 VIBRATION TEST	Frequency: 10-55Hz. Amplitude: 1.5mm Duration: 2 hours in each 3axes
3-6 TEMPERATURE SHOCK TEST	<p>Temperature: <math>-40^{\circ}\text{C} \pm 3^{\circ}\text{C}</math>      <math>\longleftrightarrow</math>      <math>+85^{\circ}\text{C} \pm 3^{\circ}\text{C}</math>      Cycle: 20 cycles Duration: 2 hour      2 hour (recovery 2 hours)</p> <p>The diagram shows a temperature cycle starting at <math>-40^{\circ}\text{C}</math>, rising to <math>+85^{\circ}\text{C}</math> (2Hrs dwell), falling to <math>-40^{\circ}\text{C}</math> (2Hrs dwell), rising to <math>+85^{\circ}\text{C}</math> (2Hrs dwell), and falling to <math>-40^{\circ}\text{C}</math> (2Hrs dwell). A double-headed arrow indicates the total cycle duration is 20-40 minutes, labeled as 1 cycle.</p>
3-7 HIGH TEMPERATURE TEST	Temperature: $+85^{\circ}\text{C} \pm 3^{\circ}\text{C}$ Duration: 48 hours
3-8 LOW TEMPERATURE TEST	Temperature: $-40^{\circ}\text{C} \pm 3^{\circ}\text{C}$ Duration: 48 hours
3-9 TERMINAL STRENGTH TEST	Load : 1.0Kg Duration: 15sec. (Shall be normal)

CHANGES						
	NO.	DATE	BEFORE	AFTER	REASON OF CHANGE	SIGN.

	<b>SPECIFICATIONS</b>	4-3
	TYPE NO.	<b>HY20N08H060L020-046</b>

4.DIMENSIONS (fig. 1 )

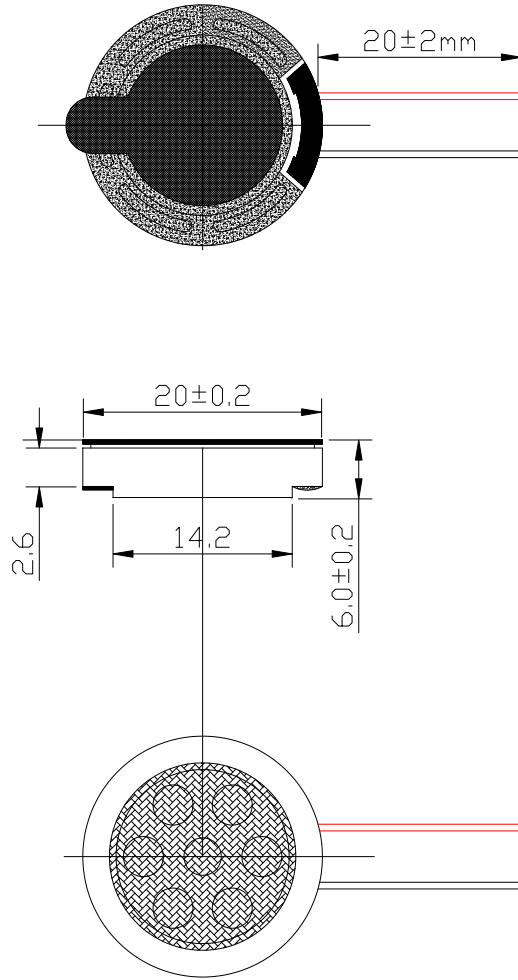

C H A N G E S						
	NO.	DATE	BEFORE	AFTER	REASON OF CHANGE	SIGN.

		<b>SPECIFICATIONS</b>				4-4
		TYPE NO.		<b>HY20N08H060L020-046</b>		

6.FREQUENCY RESPONSE CURVE (fig.3)

04/29/2010 09:49

CRY6125Y 扬声器测试仪 V91

无框

滤波器1次

DCR= \_\_\_\_\_  $\Omega$     0 1000Hz灵敏度 : 091.67 dB

ACZ: \_\_\_\_\_  $\Omega$     Qm: \_\_\_\_\_

Ueq= \_\_\_\_\_ dm3     $\Rightarrow$ 0 平均灵敏度 : 092.73 dB

Zm : \_\_\_\_\_  $\Omega$     Qe: \_\_\_\_\_

Dist.=100 cm

F0 : \_\_\_\_\_ Hz    Qt: \_\_\_\_\_

型号: \_\_\_\_\_

0 dB 参考值为 : 20.0  $\mu$ Pa    扫频速度 : 001 ms 快速    扫频模式 : 1/12 Oct

