

#10	#88	#	#
A/0	1"#	PACKING	2007/05/01
			Standard

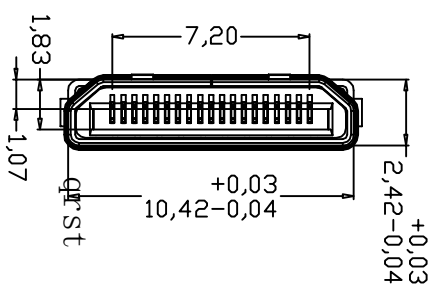
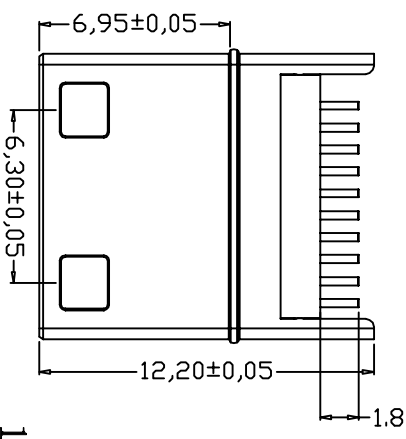
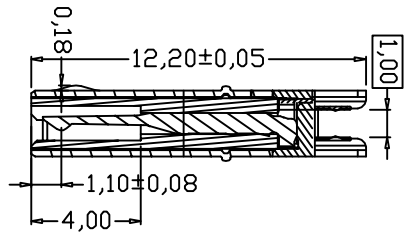
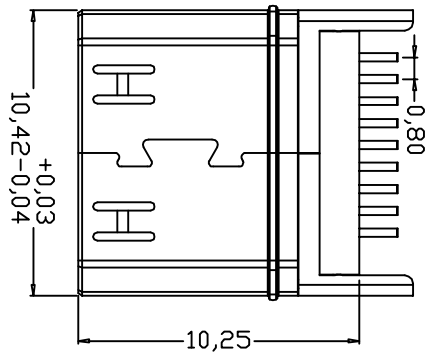

技术要求:

1. 材质: 端子: C5191 H T=0.12
胶芯: LCP,
外壳: C2680 H/SPCC
T=0.25
2. 电镀: a. 镀层: 外壳镀铜; 镍底
100U, 全金1U, 3U, 5U
b. 镀金: 端子1U" 3U" 5U" 15U"
30U"

NO	—PQ								
X.	±0.50								
X.	±0.10								
.XX	±0.05								
.XXX	±0.02								
B?	±1.00°								



Mini HDMI